

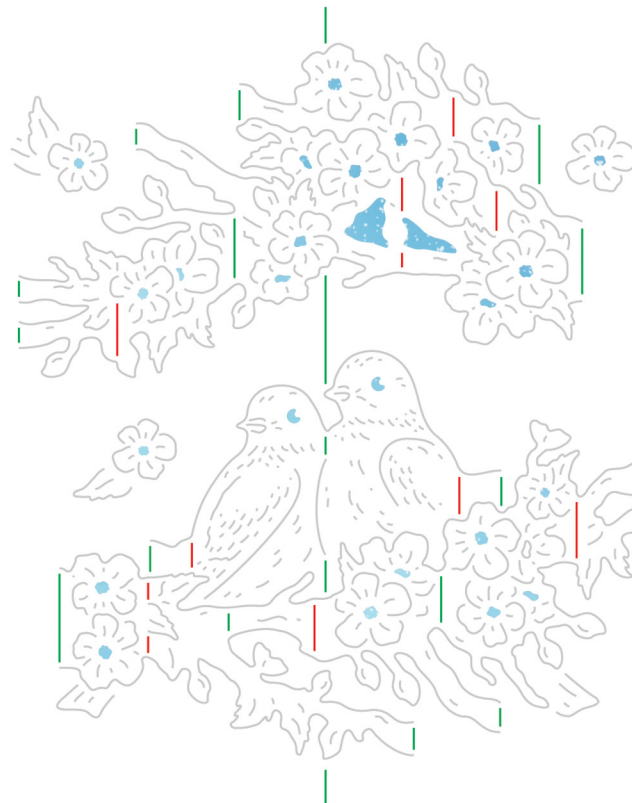

*Hunkydory*

*Moonstone*

#### Folding Guide:



■ Mountain Fold
 ■ Valley Fold

#### Folding Techniques & Terms:

**Folds are referred to as they are viewed from the front of the die cut cardstock.**

**Mountain Fold** This term is used to describe the folds that are pushed outwards in the shape of a mountain.

**Valley Folds** This term is used to describe the folds that are pushed inwards, like a valley.

**Levering** Using your middle finger behind the fold as a lever, push down the background layer with your forefinger and the base layer with your thumb.

**Pinching** This technique can be useful on smaller mountain or valley folds.

**Lifting** Use a pokey tool to help you lift elements of your pop-up that are in a space too small to fit your finger.

**Springing** Working on one small area, push together two sections by holding one in each hand and moving them in opposite directions. This should allow the card to spring back to its original position, repeat several times to create a lasting shape. Please take extra care when using this technique to prevent tearing.



Levering

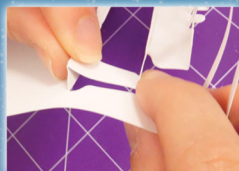

Pinching



Lifting



Springing



## How to use your Moments in Time: The Perfect Pair Die

### To make a Pop-Up card you will need:

- Moments in Time: The Perfect Pair Die Set – MSTONE120
- x1 sheet of A5 lightweight Ink-Me! (we recommend 210gsm for paper folding) - ECB201
- x1 A6 Card Blank
- Hi-Tack Tape
- Low-Tack Tape
- Die-Cutting Machine

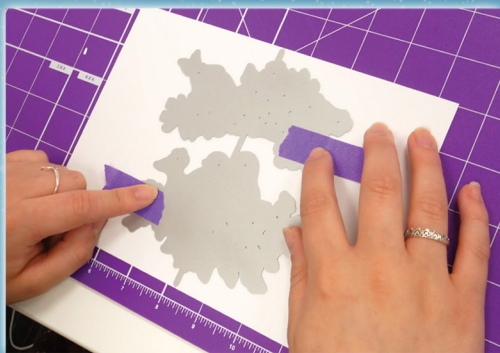

1. Begin with your A5 cardstock and find the centrepont of the longest edge, top and bottom, making a small mark. Align the narrow jutting sections on the die with these marks and secure it with Low-Tack tape before running it through your machine.



2. Using the folding guide, carefully fold the sections to create your pop-up card. The green lines show where to fold a valley fold and the red lines show a mountain fold. We have included some folding techniques.



3. When you have folded all the lines indicated, carefully fold each section to ensure it folds flat easily. It may need a few tweaks to make it lie completely flat.



4. Decorate your pop-up as desired. When you are happy with your finished pop-up, use Hi-Tack tape to secure inside an A6 card blank.

SEE FINISHED SAMPLES AND PROJECTS AT [WWW.HUNKYDORCRAFTS.CO.UK](http://WWW.HUNKYDORCRAFTS.CO.UK)  
VISIT [WWW.YOUTUBE.COM/CLUBHUNKYDORYTV](http://WWW.YOUTUBE.COM/CLUBHUNKYDORYTV) FOR DEMONSTRATION VIDEOS